

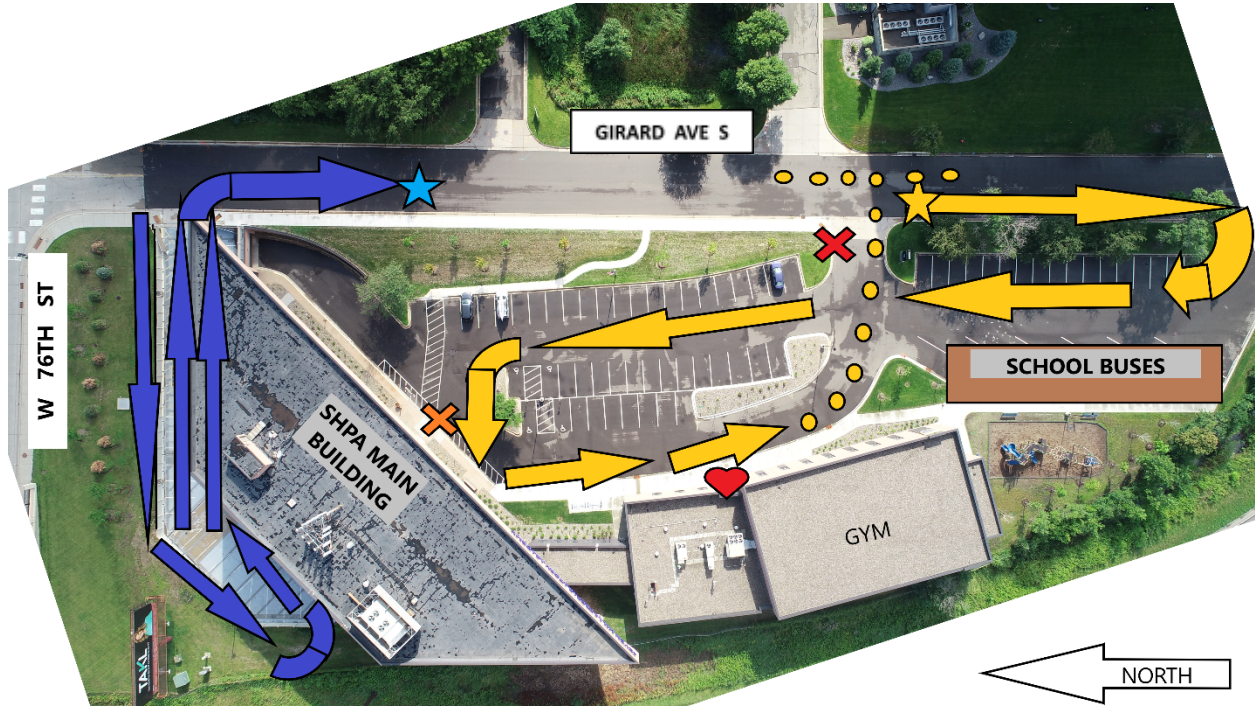







**23-24 DISMISSAL MAP**



-  ELEMENTARY PARENT PICKUP LINE
-  ELEMENTARY LINE STARTS HERE
-  DO NOT ENTER LOT HERE DURING DISMISSAL
-  DO NOT STOP HERE. PULL FORWARD TO THE CONES.
-  PICK UP ELEMENTARY STUDENTS HERE
-  ELEMENTARY PARENT PICKUP EXIT
-  MIDDLE SCHOOL PARENT PICKUP LINE
-  MIDDLE SCHOOL PARENT EXIT (RIGHT TURN ONLY)

In an effort to reduce the number of cars in our dismissal lines we will continue the Bethel's Rock parking lot pick-up zone for our students in 7-8<sup>th</sup> grade (without siblings). See the next page for details!

Please review with your students before the start off the new school year:

- Elementary students will be picked up on the sidewalk near the gym. Drivers must pull all the way up to the cones (see heart on map).
- 6<sup>th</sup> grade students (and their middle school siblings) will be picked up in the North lot outside door 2
- Middle school students with elementary aged siblings will join their siblings and get picked up in the south lot (see heart on map)
- 7<sup>th</sup>-8<sup>th</sup> grade see next page

If your student is in 7<sup>th</sup> or 8<sup>th</sup> grade and does not have other siblings in other grades they will be picked up at the Bethel's Rock parking (directly East of our school).

- Family members will enter Bethel's Rock through the North entrance off of W 76<sup>th</sup> St.
- Family members will park in the lots indicated below and will remain in their cars
- Students will be released at 3:40 and will walk across the street at the crosswalk
- All cars will exit Bethel's Rock through the North entrance on W 76<sup>th</sup> St.
- As always we ask that families drive extra cautiously through this dismissal process and discuss with their students proper safety protocols for navigating a parking lot with moving cars

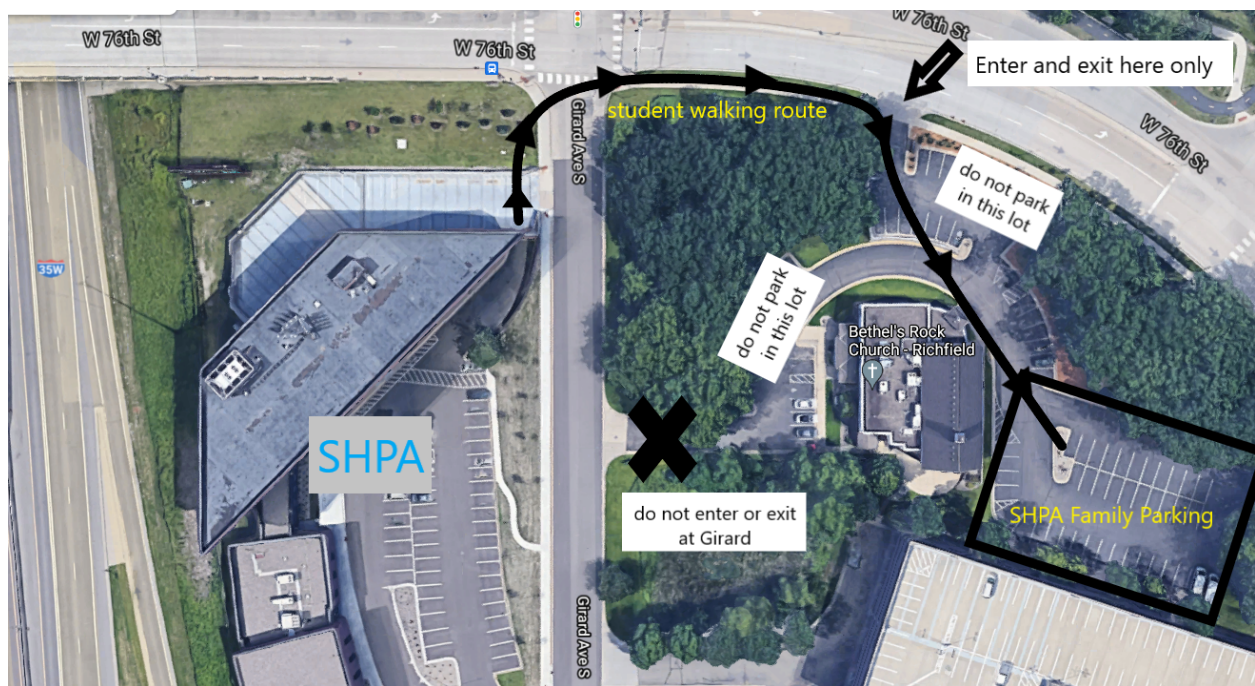

**We appreciate your cooperation and  
patience in providing a safe and efficient  
dismissal process.**